

K3HN



High-speed hole EDM by Sodick

- CNC control LK1 with SMC (Sodick Motion Control)
- LN assist software for optimum condition search
- Automatic depth measurement
- AEF (Automatic electrode feeder)
- Improved ease of operation
- Guide set 0.8 mm
- Electrode tube 20 pcs. 0.8 mm
- Splash guard
- Workpiece fixtures

Technical Specifications

X/Y/Z axis travel (mm)	300 x 400 x 300
W-Axis (Cutting axis in mm)	230 (manual)
Table dimensions (mm)	400 x 450
Max. workpiece dimensions (mm)	400 x 450 x 300
Max. workpiece weight (kg)	200
Electrode diameter (mm)	0.25 ~ 3.0
Electrode guide to table surface (mm)	70 ~ 300
Machine tool dimensions (W x D x H, mm)	1425 x 1120 x 2080
Machine tool weight (kg)	850

Dielectric tank

External dimensions (W x D x H, mm)	706 x 436 x 1350
Dielectric fluid	Water
Capacity (l)	110
Filtration method	Replaceable paper filter (HF-17)

Options

Touch panel	Guide sets 0.3 ~ 3.0 mm diameter (in 0.1 mm steps)
Remote controller	Guide sets (long design) 0.3 ~ 3.0 mm diameter (in 0.1 mm steps)
High column spec. (100 / 200mm)	100-litre dielectric tank
30-amp booster for electrode diameters up to 6.0 mm	Electrode tube 0.3 ~ 3.0 mm diameter (in 0.1 mm steps)
Rotary / indexing table	JauchSchmider Rotary table (indexing/simultaneous/movement)
W axis CNC	USB
Oscilloscope	LAN
Flush block	

K3HN



Side View

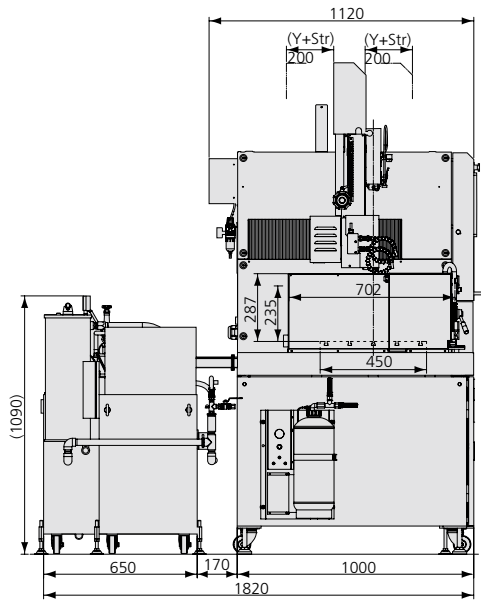

Front View

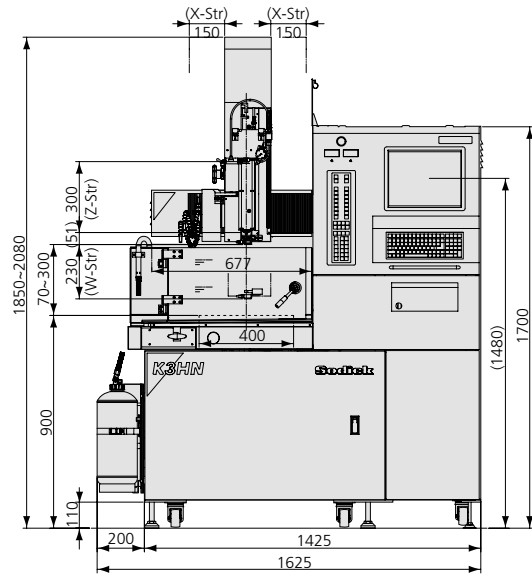

Top View

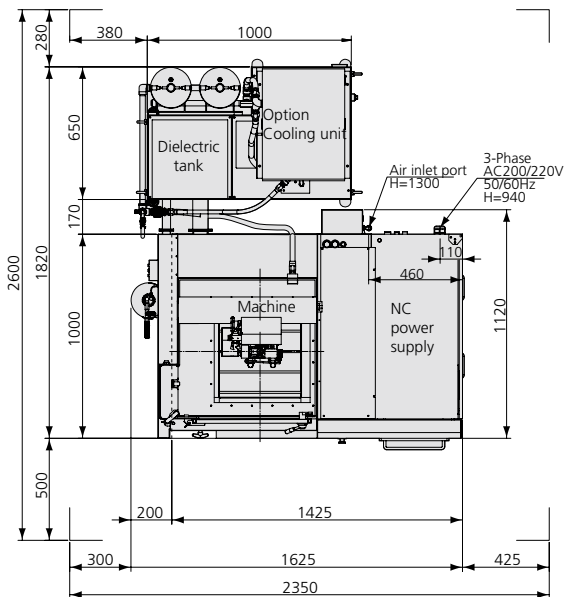

Sodick

create your future

Sodick Europe Ltd.

Rowley Drive, Baginton
Coventry, CV3 4LS
United Kingdom

Phone +44 (0) 24 7621 4314
Fax +44 (0) 24 7630 5680

Sodick Contact

email europa@sodick.eu.com
online www.sodick.org