

# EXC100L



- 10 year warranty on positioning accuracy
- Linear motor (X, Y, U, V axis)
- Linear glass scales (X, Y, U, V axis)
- Ceramic components
- Linear motor cooling unit
- 3D LQ Control LQ1W
- Heart NC for 2D form designing
- Remote controller
- Improved ease of operation
- High speed electrolysis free circuit
- SODICK Fine Corner Control
- Energy saving circuit
- Super PIKA finishing circuit
- FTII (Fine pick-up function)
- Automatic water level control
- Automatic wire threader (AWT)
- Wire end remover
- Dielectric cooling unit
- Active Power Restart (UPS)
- Voltage stabiliser
- LAN interface
- 15" TFT screen
- Work light
- Wire consumption counter
- Oil dielectric

## Technical Specifications

Max. workpiece weight (kg)	10
Max. workpiece dimensions (W x D x H, mm)	150 x 150 x 60
X/Y/Z axis travel (mm)	100 x 120 x 100
U/V axis travel	20 x 20
Taper angle at 600 mm height	±6°
Wire diameter (mm)	ø 0.02 ~ ø 0.10
Wire tension (N)	0.5 ~ 10
Max. wire speed (mm/s)	250
Distance from floor to table top (mm)	1000
Controlled axis	5
Machine tool dimensions (W x D x H, mm)	2280 x 1830 x 1990
Machine installation dimensions (mm)	2880 x 2450
Machine weight (kg)	2500

## Options

Oscilloscope	Custom colour
--------------	---------------



Side View

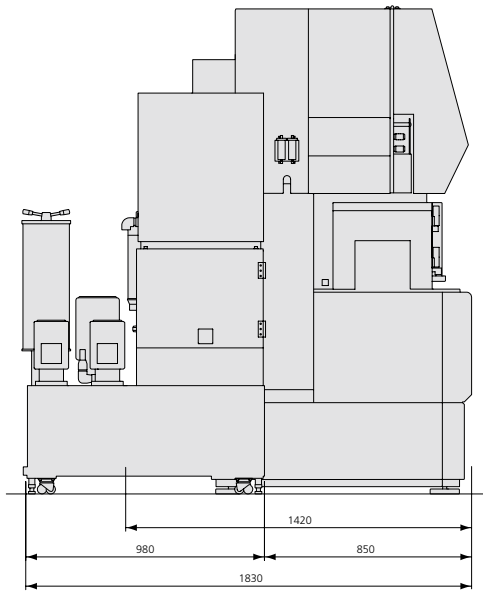

Front View

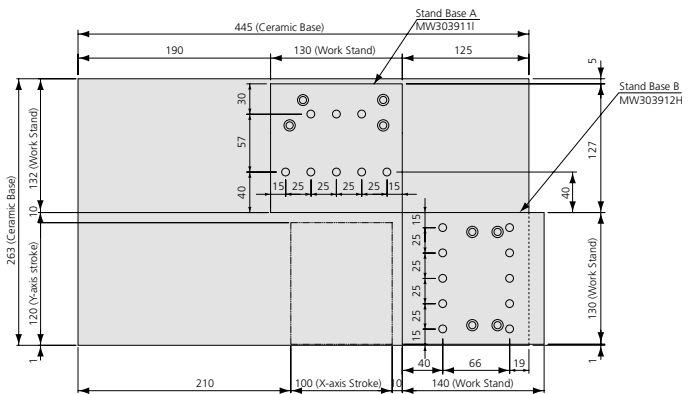
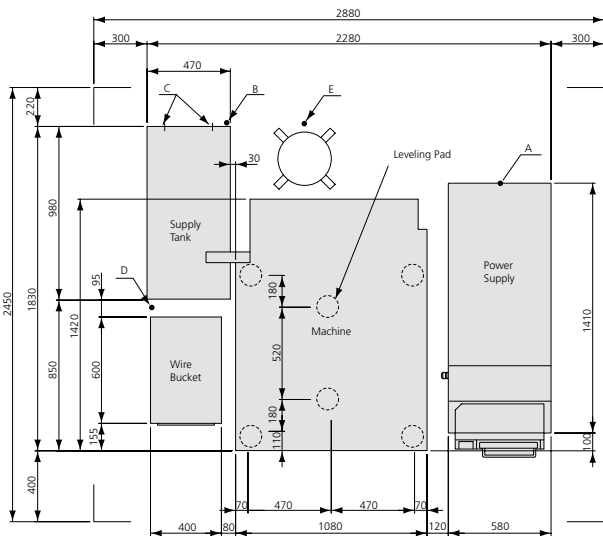
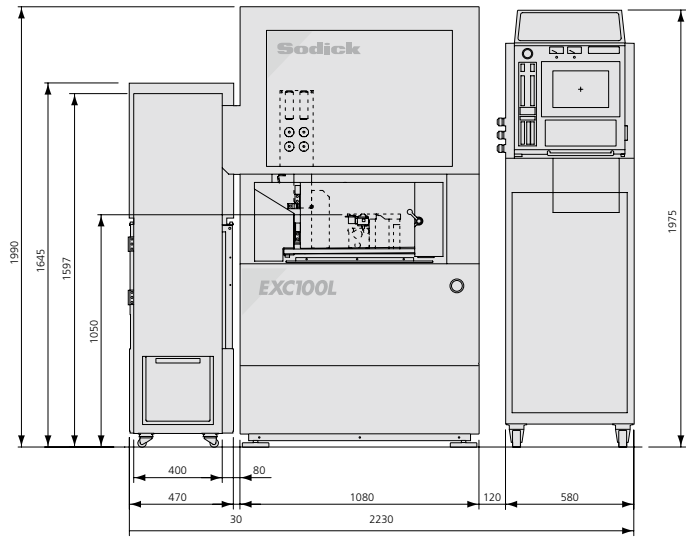

Top View

Work Table

**Sodick**

*create your future*

Sodick Europe Ltd.

Rowley Drive, Baginton  
Coventry, CV3 4LS  
United Kingdom

Phone +44 (0) 24 7621 4314  
Fax +44 (0) 24 7630 5680

Sodick Contact

email [europa@sodick.eu.com](mailto:europa@sodick.eu.com)  
online [www.sodick.org](http://www.sodick.org)