

AQ1200L



The World's Biggest Linear Motor Drive Wire-cut EDM

- 10 year warranty on positioning accuracy
- Linear motor (X, Y, U, V axis)
- Linear glass scales (X, Y, U, V axis)
- Ceramic components
- Linear motor cooling unit
- LP2WH high speed generator
- Perfect Active Control: 1Gbit/sec communication technology
- Intelligent Q3vic EDW
- Remote controller
- Rise and fall work tank
- Improved ease of operation
- High speed electrolysis free circuit
- SODICK Fine Corner Control
- Energy saving circuit
- Super PIKA finishing circuit
- FTII (Fine pick-up function)
- Automatic water level control
- Super jet AWT (Automatic wire threader)
- Wire bobbin of 20kg
- Wire end remover
- Wire chopper
- Dielectric cooling unit
- Active Power Restart (UPS)
- Voltage stabiliser
- LAN interface
- 15" TFT screen
- USB port
- Totalizing hour meter
- Work light

Technical Specifications

X / Y / Z axis travel (mm)	1,200 x 800 x 400 (Z=600 optional)
U / V axis travel (mm)	1,220 x 820
Taper angle at 150mm height	±30°
Work tank dims (mm)	1,824 x 1,400
Max. workpiece dims (mm)	1,600 x 1,200 x 400
Max. workpiece weight (kg)	4,000
Wire diameter (mm)	ø 0,15 - ø 0,33
Wire tension (N)	3 - 23
Max. wire speed (mm/s)	420
Distance from floor to table top (mm)	1,200
Controlled axes	5
Machine tool dimensions (W x D x H mm)	4,140 x 3,935 x 2,510
Machine installation dimensions (mm)	5,200 x 5,200
Machine weight (kg)	11,000
Air flow	0.5 MPa, 30 NL/min

Dielectric Tank

External dimensions (W x D x H, mm)	-
Tank weight (kg)	850 (Main) + 550 (Sub)
Capacity (liter)	3000
Filtration method	4 replaceable paper filters

Options

Z=600mm submerged cutting height
Taper flex 45 (for taper cutting up to 45°)
Oscilloscope
6/8-axis simultaneous
Custom color

* regional option



Side View

Front View

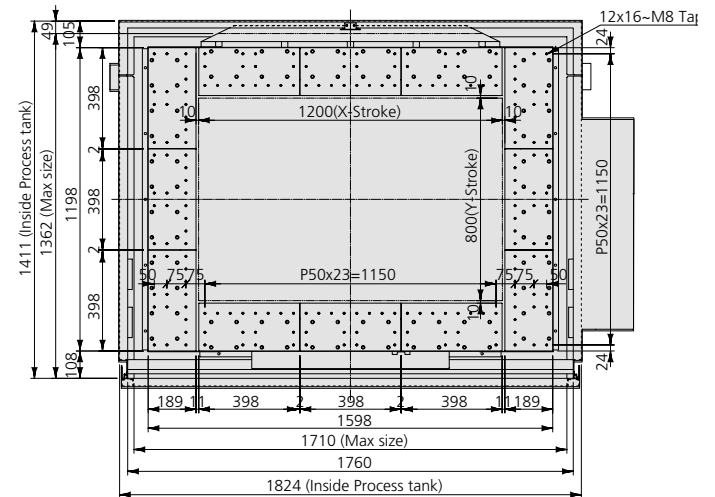
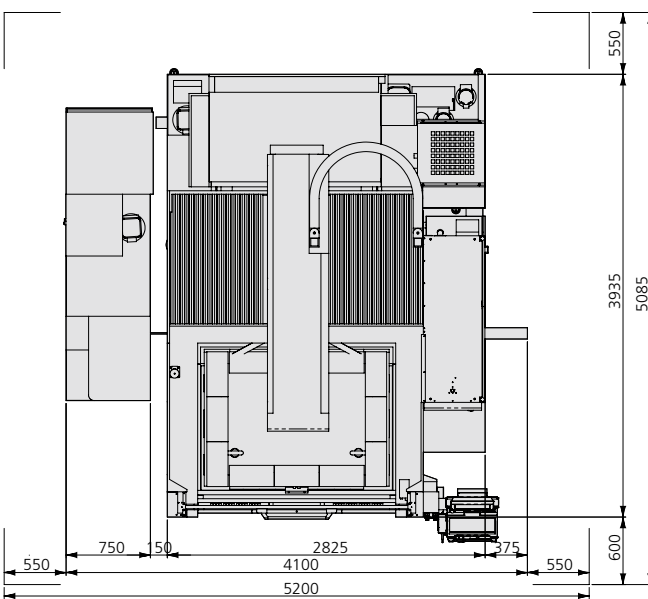
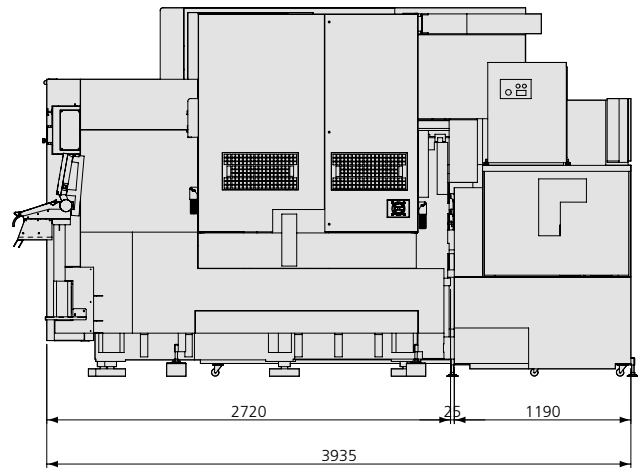
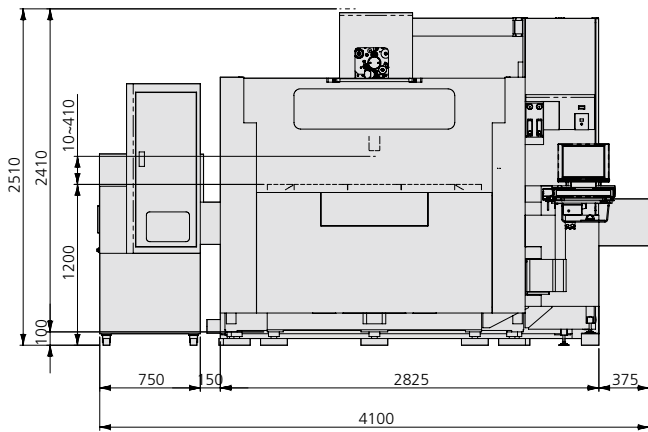

Top View

Work Table

Sodick

create your future

Sodick Europe Ltd.

Rowley Drive, Baginton
Coventry, CV3 4FG
United Kingdom

Phone +44 (0) 24 7621 4314
Fax +44 (0) 24 7630 5680

Sodick Contact

email europa@sodick.eu.com
online www.sodick.org